

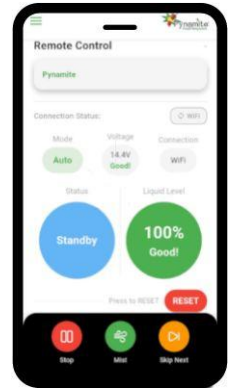

Cube Pro Manual



View our informational installation videos at

<https://www.mosquitoesinthemist.com/mosquito-misting-installation-and-setup-videos/>

SAFETY PRECAUTIONS

- Position the unit on firm level ground where it is free from flooding or exposure to irrigation spray.
- Plug the power cord into a GFCI protected outlet.
- Do not use an extension cord.
- Unit requires a 120V and 15 amp circuit. Test with multimeter. Contact an electrician if unsure.
- Disconnect unit from power source if replacing components.
- Replace fuses only with those of equivalent value.
- Motor can get hot with continuous running. The Cube Pro system is designed for intermittent duty cycles.



BEFORE INSTALLATION

The Pynamite Cube is shipped with the drain valve cap removed. Hand-tighten it in place before filling the Cube. Do not discard the viton o-ring inside the cap.

DOWNLOAD THE APP

- Go to iOS App store or Android Play Store, depending on your device. Type **Pynamite Wi-Fi/LTE** in the search bar.
- Download and then open the Pynamite Wi-Fi/LTE app. **Be sure to select the green Wi-Fi/LTE app NOT the white Bluetooth app.**



The App will be used:

- to set-up and configure the settings for the system
- as the remote control
- view system status
- to update any future firmware or software updates

THE CONTROLLER



Do not get the controller wet

1. POWER

- Press the Power button to turn the system ON. The green LED indicates the system is ON.
NOTE: The app default is 0 nozzles, the system will not mist until the controller is paired with the app and the nozzle count is increased to at least 1 nozzle in the Set Up screen.
- Press the Power button for 2 seconds to turn the system OFF.

2. LIQUID LEVEL STATUS shows the liquid level in the tank

- Green 100%-26%
- Yellow 25%-11%
- Red 10%-1%
- Blinking Red 0% - System will not mist until Liquid Level has been manually reset.

TO RESET THE LIQUID LEVEL

- Press the Stop button on the controller until the Power LED blinks green indicating the Liquid level has been reset to 100%
- Press the RESET button in the app under the Liquid Level indicator. Choose 25%, 50%, 75% or 100% from the app.

NOTE: Liquid Level must be manually reset every time the system is refilled.

3. MIST BUTTON

- Press the Mist button to initiate a mist. Default length is 45 seconds. Mist length is the same duration as the app remote control mist length and can be changed in the System Setup screen.
- Press and hold the Mist button for 5 seconds to initiate a 180 second Inspect cycle.

NOTE: The system will first agitate before it mists if agitation is turned ON and the system will mist Zone 1 and then Zone 2 if the optional Zone Kit is installed and Zone 2 is turned ON.

4. STOP MIST BUTTON

- Press the Stop Mist button to immediately stop a Mist.
- Press and hold the Stop button for about 10 seconds to reset the Liquid Level to 100%. The Power button LED will flash indicating the Liquid Level has been reset.

CONTROLLER LED LIGHTS

POWER BUTTON

- Green Solid - System has Power
- Blue Solid - Controller connected through Bluetooth
- Solid White - Controller connected through Wi-Fi
- Green Flashing - Liquid Level is Resetting to 100%

LIQUID LEVEL BUTTON

- Green Solid - Liquid Level is 100% to 25%
- Yellow Solid - Liquid Level is 24% to 11%
- Red Solid - Liquid Level is 10% to 1%
- Red Flashing - Liquid level is 0%

MIST BUTTON

- Blank - Standby
- Red - Nozzles are set to 0
- Red Solid - Skip Next Scheduled Mist is Activated
- Aqua Blue Solid - Agitating
- Yellow Solid - Dumping Pressure
- Light Green Solid - Energizing Solenoid Valve(s)
- Green Solid - Misting
- Purple Flashing - Mist Saver is Activated.
- Purple Solid - Freeze is Activated

NOTE: System will not perform scheduled mist cycles in Mist Saver or Freeze.

NOTE: System stays in Freeze Status until the Power button is pressed to turn it off. When powered back on, it will automatically return to Freeze, Mist Saver, or Standby based on current temperature.

MENU

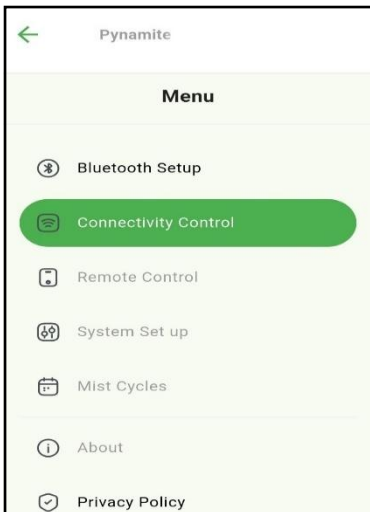

Pressing the Menu  button in the upper left-hand corner of the screen will open the Menu page.

The screen that is currently displayed will be highlighted.

Pressing on any of the menu options will take the user to the selected screen.

NOTE: Connectivity Control opens the Wi-Fi page.

BLUETOOTH CONNECTION SCREEN

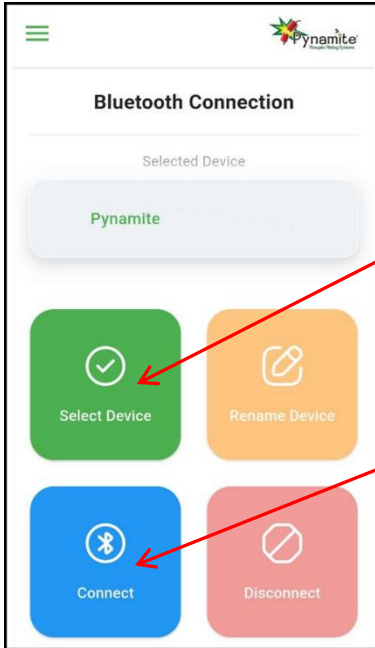

This screen is used to connect to a controller.

- Press “Allow When Using” to share location to keep accurate time.
- Press “Allow” for app to use Bluetooth.

1. PRESS the Select Device button to navigate to your system.

2. PRESS your device name to access your system.

3. PRESS Connect and settings will load.

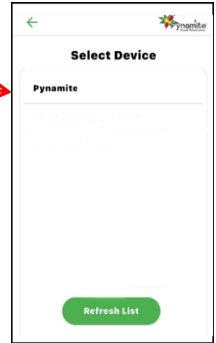

While connecting, the **Power** LED on the controller will turn **blue** indicating a Bluetooth connection is being established. It will revert to **green** when the app is no longer connected or **white** when a Wi-Fi connection is established.

NOTE: Once connected, you will be taken to the **Connectivity Control** page. If you wish to **rename your device**, you need to do so while **you are still in the Bluetooth connection**.

Renaming the Device:

- Press Menu ☰
- Choose Bluetooth Setup page
- Press Rename Device
- Type in the desired name
- Press Save

Disconnecting the Device:

- Press the Disconnect button to disconnect the app from the selected device.

NOTE: The controller syncs its time with your phone during the initial Bluetooth connection. After Daylight Saving Time changes, reconnect via Bluetooth to update the time.

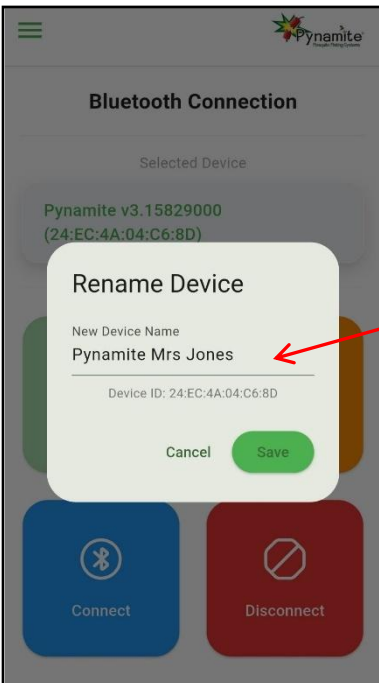

CONNECTIVITY CONTROL

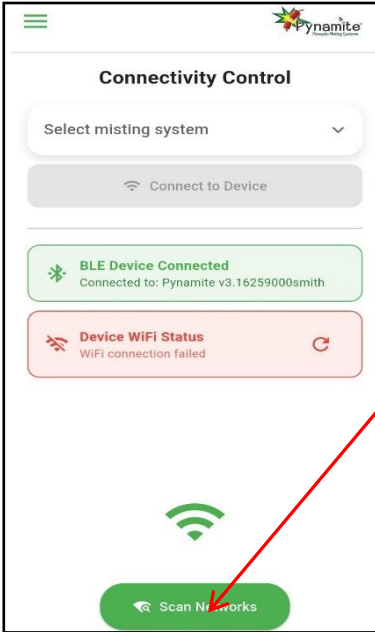

The **Connectivity Control** page lets you connect the controller to Wi-Fi and access it remotely when you're not nearby.

TO ESTABLISH A WI-FI CONNECTION:

If not taken to this page press Menu  choose Connectivity Control page

- Press **Scan Network**
- Select your network.

NOTE: If the controller cannot connect to your Wi-Fi network, this is due to insufficient signal strength at the installation site. A Wi-Fi booster or range extender may be required to ensure reliable connectivity.

- Enter the password.
- Press **Connect**.

Once connected, a white **Power LED** on the controller will indicate a Wi-Fi connection. The LED will remain white unless the Wi-Fi connection is lost. The controller will try to auto connect to Wi-Fi if the signal is lost.

NOTE: **Multiple controllers can connect to one Wi-Fi controller. Each phone must first connect via Bluetooth, then can access it over Wi-Fi. Each phone must be added one at a time.**

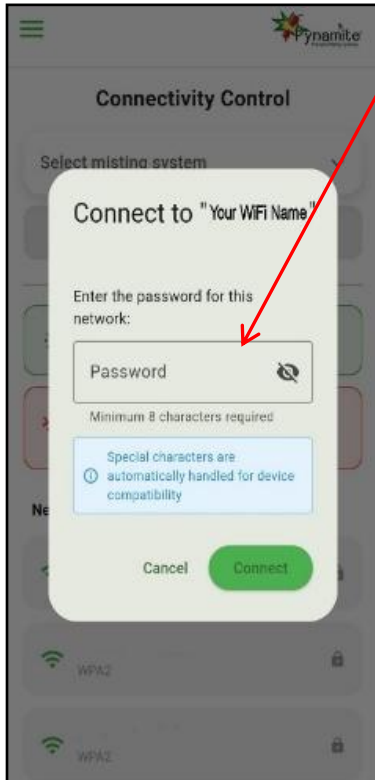

TO ACCESS CONTROLLER WHEN AWAY:

Open the app. The app may try to auto connect to your system, if you were recently connected.

If it does not auto connect:

- Press Menu 
- Press Connectivity Control page
- Press Select Misting System
- Choose desired system in the dropdown
- Press the green "Press to Connect to XXXXX" button

REMOTE CONTROL SCREEN

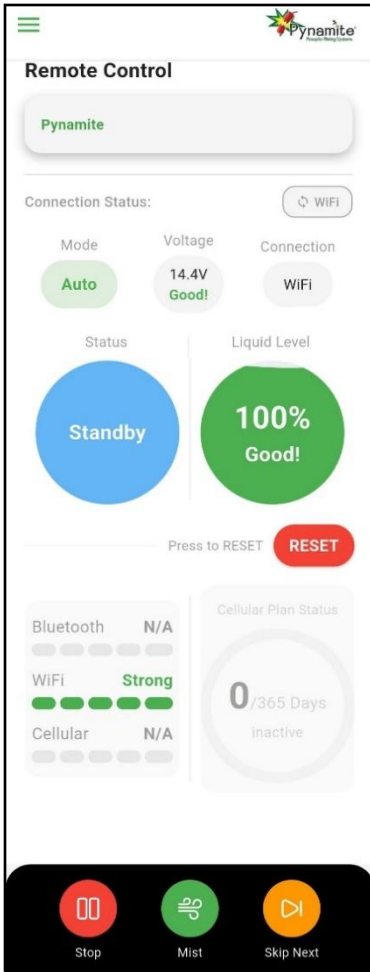

Current system is displayed

MODE: displays AUTO or MANUAL. The system must be in **Auto** mode for scheduled mists and stir cycles to run. Change the mode in the Set Up screen.

VOLTAGE: displays voltage from the controller.

CONNECTION: will display Ble or Wi-Fi.

SYSTEM STATUS: displays the current state of the misting system:

- STANDBY – system is idle
- AGITATE – system agitating
- MIST – system misting
- DUMP – system in dump phase
- STIR – system performing a stir operation – additional agitating at 12pm & 3pm
- EMPTY – tank is empty - system will not mist until Liquid Level is reset
- STANDBY/SKIP – skip the next mist has been activated
- MIST SAVER – suspends misting if the temperature goes below 50F.
- FREEZE – suspends misting if the temperature goes below 32F.

NOTE: System will not perform scheduled mist cycles in Mist Saver or Freeze.

The system stays in **Freeze Status** until the Power button is pressed to turn it off. When powered back on, it will automatically return to **Freeze, Mist Saver, or Standby** based on current temperature.

NOTE: Freeze protection is a safety backup; it does not replace proper winterization, which is required to prevent damage and avoid voiding the warranty.

Mist Saver & Freeze Accuracy

Mist Saver and Freeze Protection are most accurate when connected to Wi-Fi, using real-time internet weather data. In Bluetooth mode, the controller uses an internal thermistor, which may read slightly higher due to heat from internal electronics.

REMOTE CONTROL SCREEN CONTINUED

LIQUID LEVEL STATUS: displays the current % level of liquid in the tank.

- Green = 100% to 25%
- Yellow = 24% to 11%
- Red = 10% to 0%
- Red Blinking = Empty

NOTE: The system will stop misting at 0%. Liquid Level must be manually reset every time you refill the system.

To reset Liquid Level:

- Press the RESET button under the liquid level on the Remote Control screen in the app
- Press desired level - 25%, 50%, 75% or 100%
- Press Confirm

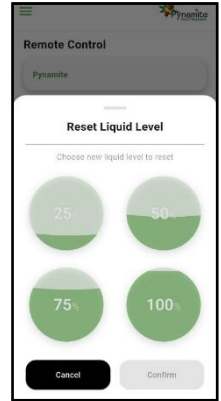

You can also set the Liquid Level from the controller by pressing the **STOP** button for about 10 seconds until **POWER** button LED flashes green 5 times to indicate liquid level has been reset to 100%.

Running the pump dry can damage the pump and void the warranty.

SIGNAL STRENGTH: displays the strength of signal that the system is connected to. Bluetooth and Wi-Fi are the only options currently.

CELLULAR RENEWAL: LTE capability may be available as an optional upgrade in the future.

BUTTONS

STOP MIST BUTTON - Press the Stop Mist button to terminate any misting cycle and stop other activities in progress.

MIST BUTTON - Press the Mist button to begin a remote manual misting cycle.

NOTE: The app default is 0 nozzles, the system will not mist until the controller is paired with the app and the nozzle count is increased to at least 1 nozzle in the Set-Up screen. It is best to input the actual number of nozzles so the liquid level status will be accurate.

SKIP NEXT MIST - Press the Skip Next Mist button to skip the next scheduled automatic mist cycle. Confirm in the pop-up window. The Status on the remote control will show STANDBY/SKIP. Pressing the button again will change the Status back to STANDBY and the next mist will initiate on schedule.

System Set Up

Pynamite

Select Choice

Auto Manual

Agitation (30 seconds)

Stir (30 seconds)
12:00PM & 3:00PM

Mist Saver

Zone 1
Enable/Disable Zone 1

Number of nozzles 30

Tank Size (gal) 55
Default 55 gal

Mist Days

S M T W T F S

Zone 2
Use only with zone kit

Number of Nozzles 0

Mist Days

S M T W T F S

Dump (sec) 15
Default 15 sec

Remote Duration (sec) 45
Default 45 sec

Remote Counter 20

Remote Counter Reset **RESET**

Select Choice: Manual and Auto mode.

NOTE: System must be in Auto mode for scheduled mists and stir operations to activate.

Agitation: Before mist cycles. Typically leave ON.

Stir: Additional twice daily agitation.

Mist Saver: Suspends scheduled misting when the temperature falls below 50F. Scheduled mist cycles will resume when the temp is above 50F.

NOTE: Mist Saver is most accurate when in Wi-Fi. In Bluetooth mode, the controller uses an internal thermistor, which is less accurate.

Zone 1 Settings:

- Toggle ON
- Number of Nozzles – Range: 0–60 (default 0). **The system will not mist until paired with the app and at least one nozzle is assigned to the active zone.** Enter the correct nozzle count to maintain accurate Liquid Level tracking.
- Nozzle Flow Rate – Range: 1-90 ml, typically leave as default.
- Tank Size – Range: 1-250 gallons, typically 55 gallons.
- Mist Days – typically leave all days toggled ON.

Zone 2 Settings: Configure like Zone 1 if optional Zone Kit was purchased. At least 1 nozzle must be input for Zone 2 to mist.

Dump: Relieves the pressure off the nozzles. Typically leave as default.

Remote Duration: Length of a manually activated mist cycle through app or controller.

Remote Counter: Number of manual mist cycles started from the app.

Remote Reset: Resets the remote counter to zero.

MIST CYCLES SCREEN

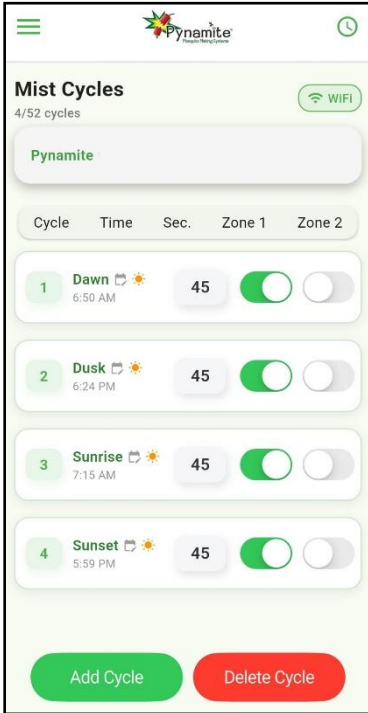

Cycles 1 & 2 - Dawn & Dusk: the most effective times to mist for mosquitoes. **Dawn & Dusk cycles cannot be changed, deleted - only toggled ON or OFF.**

Cycles 3 & 4 - Sunrise & Sunset: May be used instead of, or in addition to, Dawn & Dusk cycles. **Sunrise & Sunset cycles cannot be changed, deleted - only toggled ON or OFF.**

Add a Cycle Button:

- Select a start time and duration.
- If an optional zone kit is installed and enabled, a toggle will appear to select **Zone 1, Zone 2, or Both Zones.**
- All added cycles can be changed, deleted, or toggled ON or OFF.

Delete a Cycle Button:

- Press **Delete Cycle.**
- Check the box next to the cycle(s) you want to remove.

Note: Dawn/Dusk and Sunrise/Sunset cycles cannot be deleted - only toggled ON or OFF.

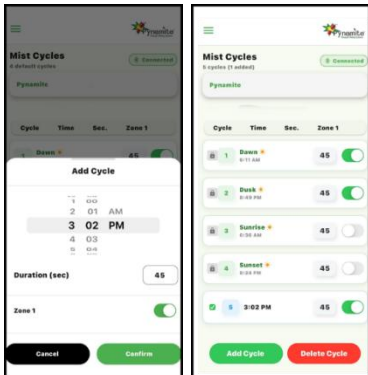

RECOMMENDED MIST TIMES

MOSQUITOES & SPIDERS: 45 second mists at Dawn, Dusk and 10:30 pm

FLIES: 30-45 second mists at Dawn, 8:00 am, 10:30 am, 1:00 pm, 3:30 pm, 6:00 pm, Dusk, and 10:30 pm.

NO-SEE-UMS: 15-30 second mists at Dawn and Dusk and every 30-60 minutes when they are most active, typically in the morning or afternoon.

It may take a few days to gain control of your yard initially, and occasionally after heavy rain or a new hatching cycle. Use the app's remote control feature to mist between scheduled cycles as needed

ABOUT SCREEN

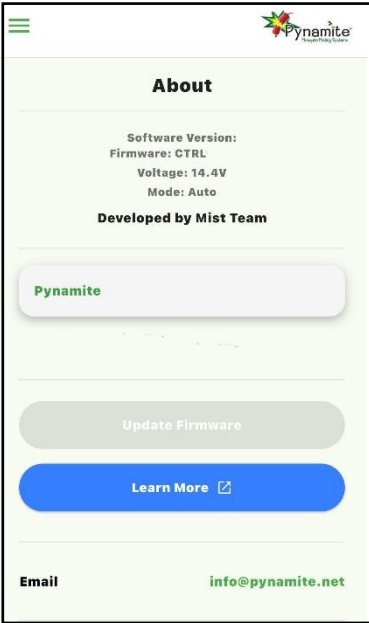

This screen is used to update firmware on the controller and link to the Pynamite website for further information on the system.

Updating the firmware can only be done while in Bluetooth connection. See Functions That Require Bluetooth Connection for instructions on establishing a Bluetooth connection once a Wi-Fi connection has been established.

ACCESSING MULTIPLE WI-FI CONTROLLERS

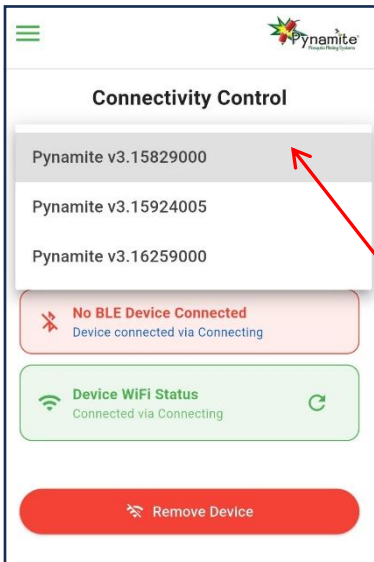

Manage multiple controllers from the **Connectivity Control** page.

Before a controller appears in the list:

- It must first be connected to the phone via **Bluetooth**.
- It must also be connected to the local **Wi-Fi network**.

To access a controller:

- Press the **down arrow** next to “Select misting system”.
- Select the desired controller from the drop-down menu.
- Press the green **“Press to Connect to XXXXX”** button.

If the controller is connected to Wi-Fi and you have access, the **Remote Control** page will open and all functions will be available.

Remove Device - To remove a device from appearing in the drop down, select the controller from drop down and press Remove Device.

Note: Only Wi-Fi controllers, currently connected to a Wi-Fi network will be accessible through the drop down.

FUNCTIONS THAT REQUIRE BLUETOOTH CONNECTION

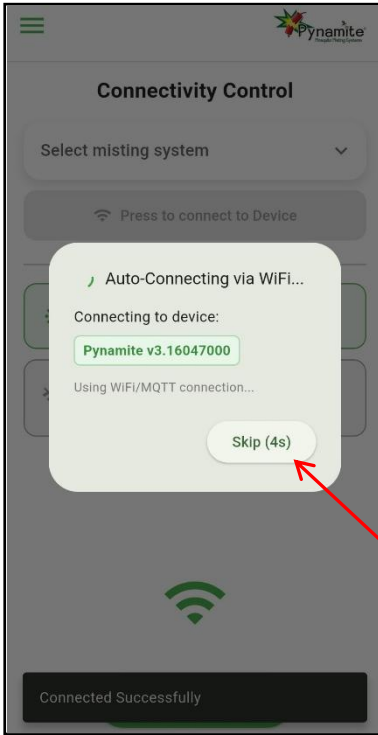

Some features require a **Bluetooth (BLE)** connection rather than Wi-Fi.

How to check your connection

- A **white Power LED** on the controller indicates a Wi-Fi connection.
- The **Remote Control** page also shows your current connection - BLE or WiFi.

How to switch from Wi-Fi to Bluetooth

- Go to **Menu** ☰
- Select **Bluetooth Setup**
- Tap **Select Device**
 - If it's grayed out and **Disconnect** is red, tap **Disconnect** first
- Choose your controller
- Tap **Connect**
- The system will try to auto-connect to WiFi twice, tap **Skip both times** to stay in Bluetooth mode

The controller will automatically reconnect to Wi-Fi when available.

Revoke Shared Access

Removes all users that have access to your controller via Wi-Fi.

To revoke access:

- While in Bluetooth go to **Menu**
- Select **System Setup**
- Scroll down to the bottom of the page and tap **Revoke Shared Access**
- This removes **all users, including yourself**. All phones must reconnect via **Bluetooth** to set up access again.
- Completely close and reopen the app.
- The controller will be renamed from XXXXX0000 to XXXXX0001 in your connection screen.

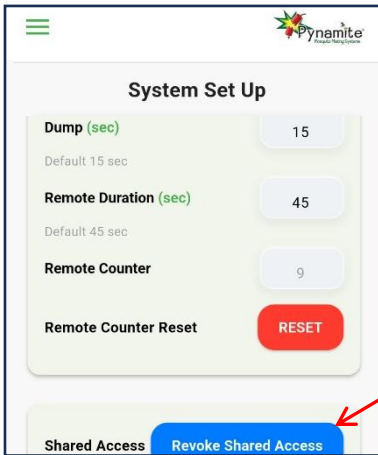

Daylight Saving Time Reset

The controller sets its time from your phone during the initial **Bluetooth** connection. When Daylight Saving Time changes, reconnect to the controller via **Bluetooth** to update the time.

Updating Firmware

Firmware updates can only be accessed and installed while connected via Bluetooth.



1. **POWER CORD** – Plug into a 120V, 15-amp GFCI outlet. Use a surge protector. Do not use an extension cord.
2. **CONTROLLER** – see operating instructions on previous pages.
3. **AGITATION/ ANIT-SIPHON VALVE and ELBOW** – Agitates liquid before each mist and prevents siphoning if tubing is cut.
4. **NOZZLE CIRCUIT ELBOW** – Starting point of the nozzle circuit. Feed tubing through a Nozzle Circuit Outlet (#6), then insert clean-cut

tubing fully, then pull back slightly to lock in place.

5. **PRESSURE RELIEF TUBE & DRAIN ELBOW** – Relieves excess pump fluid and pressure after each mist. **NOTE: DO NOT remove the drain elbow from the tank.**
6. **NOZZLE CIRCUIT OUTLETS** – Openings on the back right and left sides allow tubing to run either direction. Feeding tubing from outside the Cube may be easier before attaching to the elbow.
7. **SUCTION STRAINER** – Filters debris before it enters the pump and helps prevent clogged nozzles. Clean if clogged (see page 14).
8. **PUMP AND MOTOR** – Supports up to 60 nozzles. **NOTE: Remove the shipping strap for quieter operation.**
9. **LOUVERS** – Cover drainage holes (see page 13). If liquid exits here, inspect immediately for leaks. **NOTE: To protect electronics, never operate without intact louvers.**
10. **8" MANWAY** – Access point for filling, maintenance, and winterizing. **Note: Never operate with it open.**

NOT PICTURED

Outside the Cube

- **RECESSED DRAIN** – Bottom right of tank. Ensure the Viton O-ring is in place and hand-tighten cap before adding liquid.

Inside the Cube

- **SUCTION STRAINER TUBE** – Draws liquid from tank to pump.
- **PRESSURE RELIEF TUBE** – Returns excess pressure to tank.
- **MIXING EDUCTOR TUBE** – Mixes solution before misting.

ATTACHING THE DRAIN CAP



Make sure the viton o-ring is in place and hand-tighten the drain cap on to the drain located in the back right hand corner of the cube, before filling the cube. **Do not overtighten.**

ATTACHING THE LOUVERS



The louvers cover holes in the sides of the cube that allows water to drain out if the cube gets overfilled or a hose breaks.

- While the lid on the Cube is closed; center the louver over round the hole on each side, **just under the lid. Do not attach the louvers to the lid.** Make sure the louvers point down.
- Attach the louvers with the provided screws. Tighten just until snug. **CAUTION: Do not over tighten the screws.**

NOTE: Never operate the Cube without the louvers or with broken louvers as water (rain, irrigation, etc...) can enter the Cube and damage the electronics.

INLINE FILTER



The inline nozzle filter is installed just outside the system. It is a secondary filter that cleans the fluid before it reaches the nozzles. The inline filter should be installed in the nozzle circuit before any nozzles or fittings (or optional zone kit if installed). **Insert the tubing coming out of the Cube system into the end of the inline filter marked IN.** Insert another piece of tubing into the end of the filter and begin the nozzle circuit.

NOTE: Install the inline filter so that the word IN is connected to the tubing coming out of the system.

SUCTION STRAINER



The Cube Pro has two filters to keep the nozzles clean and clog-free. The first is the **suction strainer**, the “window” inside the tank. Check it each time the system is refilled. If it’s dirty or clogged, clean it - and likely the inside of the tank as well.

To clean it, pull the suction hose up through the hole so the strainer can be moved outside the Cube (as shown in the picture). Open the clear bowl **outside the Cube** to prevent liquid from draining inside. Remove the mesh filter, rinse the filter and nylon bowl, then reattach the bowl, making sure the O-ring is in place.

Note: Do not leave water in the clear suction strainer bowl during winter. Freezing water can crack the bowl. Remove the bowl and store it indoors for the winter.

USING THE PRESSURE TESTER



The **Pressure Tester** is used to check system pressure at the unit or anywhere along the nozzle circuit.

To test pressure at the system, insert the pressure tester into the nozzle circuit elbow inside the Cube. To remove tubing or the pressure tester from a fitting, press down on the fitting’s collet while pulling the tubing or tester out.

The pressure tester can also be used along the nozzle circuit to check for leaks. Remove a nozzle and adapter from a tee fitting, then insert the pressure tester into that fitting.

Note: Do not leave the pressure tester attached during normal operation. Store it in a place protected from freezing so it is ready when needed.

TUBE CUTTER



The tube cutter is used to make straight cuts in the tubing. The U-shape on the back of the tube cutter is a tube release tool. Use it push down on the springy collet of a fitting to release the tubing.

NOZZLE CIRCUIT ASSEMBLY

Nozzle Assembly:

- Insert the nozzle and 45° adapter into the center hole of a union tee by pushing the adapter into the tee and then swiftly pulling back to lock the nozzle and adapter in place.

Riser Assembly:

- Insert the tubing sticking through the **bottom** of the riser into the center hole of a union tee.
- Insert the nozzle and 45° adapter into the union at the **top** of the copper riser. Secure the adapter by pushing it all the way in and then swiftly pulling back to lock the adapter in place.

NOTE: Ensure the nozzles are tightly screwed into the 45° adapter. Do not loosen the nozzle from the adapter or the tip from the nozzle. That will cause a pressure loss.

The most effective nozzle circuit is one that forms a complete perimeter barrier around the area you want to protect. Nozzles/risers are typically placed 10 feet apart.

The Cube Pro with its high pressure pump and motor is strong enough to run up to 60 nozzles/risers without having to create a closed loop. Insert a union tee anywhere in the line to run in a different direction. Insert a plug into the open hole(s) of the union tee(s) at the end of all the runs.

Starting a Nozzle/Riser Circuit:

- Run the end of the tubing in through one of the Nozzle Circuit Outlets (holes) found in the back corners on either side of the Cube. See #6 on page 12.
- Insert the tubing into the nozzle circuit fitting inside the Cube. See #4 on page 12.
- Using the Tube Cutter, cut the tubing at the first nozzle placement or tee and insert the tubing into a side hole of a union tee.
- Continue cutting the tubing to the desired length, usually 10 feet, and attaching to the remaining union tees on the nozzles/risers to create the nozzle circuit.
- Secure the nozzles with the included tube clamps. Place a tube clamp on the tubing on each side of the nozzle to hold the nozzle in place and one every 3-5 feet to hold the tubing in place.
 - Be sure to pull tubing snug, but not tight, before tightening the clamp to keep the tubing from sagging. **NOTE: When installing on Stucco, take precautions to ensure water does not seep into Stucco. Contact Pynamite for specific instructions, 866-986-5586.**

Tips & Time Savers:

- Ensure every tubing cut is a straight clean cut. Even a small angle can cause a leak in the fitting.
- Push the tubing all the way into the fitting and then swiftly pull back to lock it in place to avoid leaks. You should feel 2 points of resistance for the tubing to be fully seated. Wetting the tubing before inserting it into the fitting will help it slide in easier.
- The tubing should not sag between nozzles or clamps, but don't pull it too tightly.
- To release a nozzle or tubing, hold down the springy collet on the fitting and pull to remove nozzle or tubing. The U-shape on the back of the tube cutter works well to hold the springy collet down.
- When the installation is complete, check the entire nozzle circuit to make sure there are no leaks and that the tubing is inserted into all the fittings properly. The tubing should be snug but not tight between nozzles and clamps. Use the pressure gauge (see page 14) to check the pressure along the nozzle circuit.
- Don't bury the riser tubing until after the system has been pressure tested and no leaks were found.
- Tubing does not need to be protected underground but should be protected in 12"-15" of PVC pipe or similar material up from the ground for every transition to avoid cuts from feisty squirrels and weed whackers.



NOZZLE CLEANING



Pynamite nozzle tips are cleanable. The tip (1) can be unscrewed and soaked in 50/50 hot vinegar/water solution to remove calcium deposits. Hand tighten to reassemble.

NOTE: Only soak the nozzle tip in the vinegar solution. Do not soak the spring, ball, or o-rings.

SYSTEM SET UP

Once the nozzle circuit has been installed and connected to the Cube, the system needs to be purged and tested before filling it with insecticide.

- **Turn the system OFF** and fill the Cube about halfway with water. **DO NOT ADD INSECTICIDE. DO NOT GET THE CONTROLLER WET.**
- Remove the last nozzle on the circuit (or nozzles if you have different runs).
- Turn the system ON and **CLOSE the Manway Cover**. Initiate a 180 second Inspect cycle by pressing and HOLDING the Mist button for 5 seconds **then release**, to purge the air out of the system. **NOTE: The system will not mist with a quick touch on the Mist button until the controller is paired with the app and the nozzle count is set to at least 1 in the Set Up screen.**
- After the agitation cycle, the system will start misting. **Verify there are no leaks inside the Cube before walking away.** Water and air will come out of the open nozzle(s). Initiate several Inspect cycles to purge the air out of the lines until the water runs freely without sputtering.
- Once the water is running without air sputtering and the inspect cycles ends, **replace the removed nozzle(s).**
- Attach the pressure tester along the nozzle circuit to test the system pressure by removing a nozzle and adapter from a tee fitting and inserting the pressure tester into that fitting.
- Be sure all nozzles have been replaced on the nozzle circuit. Refer to pressure tester instructions on page 14.
- Press and hold the Mist button for 5 seconds. Once misting, if the pressure does not reach at least 150 psi, check tubing connections making sure water is not leaking out or air is not being sucked in.
- Once the pressure is verified, remove the pressure tester and reattach the nozzle.
- **Turn the system OFF**, pour in the insecticide, and continue filling the Cube with water. Turn the System ON. **NOTE: DO NOT OVERFILL THE CUBE, WATER CAN DAMAGE THE ELECTRONICS AND PUMP AND MOTOR.**

WARNINGS:

DO NOT LEAVE THE SYSTEM UNATTENDED WHILE FILLING

DO NOT LET THE HOSE COME IN CONTACT WITH SOLUTION IN THE TANK

UNPLUG THE SYSTEM WHILE SERVICING

NOTE: When the Cube is full, you may notice a slight bulge. This is common with rectangular tanks and is not a functional concern.

INSECTICIDES REGISTERED FOR MISTING

Only products that are water based, approved by the EPA and labeled for use in an Automated Misting System can be used in a Pynamite Misting System. **Products containing Petroleum Distillates should never be used regardless of labeling. Additionally, do not use Natural Products containing essential oils such as wintergreen, peppermint and similar. Using unauthorized products can damage your system as well as your property and will void the warranty.** To see approved misting concentrates, go to www.mosquitoesinthemist.com and click on the Misting Solutions tab.

Never mix different misting concentrates inside the Cube. Always thoroughly clean out the tank and run a couple freshwater manual mists through the nozzles before changing products. Perform this clean out procedure after every 2-3 refills to keep the Cube tank clean and algae/bacteria free.

LIQUID LEVEL RESET

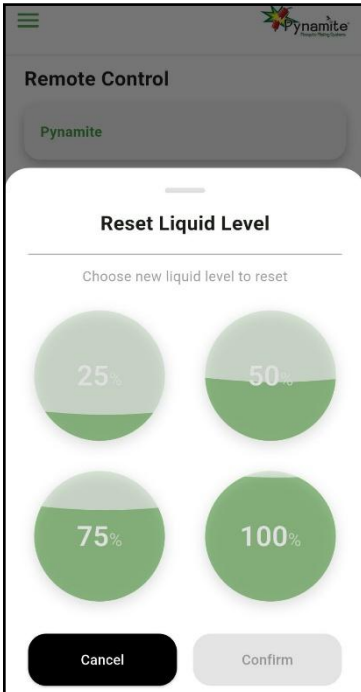

The Liquid Level must be manually RESET each time the system is refilled.

The Liquid Level is shown on the Remote Control page of the app and the controller itself. The system uses math to determine when it is time to refill (number of nozzles, duration and frequency of mists). It does not have a liquid level sensor. When the system determines the tank is at 0% it will not mist until the Liquid Level is manually reset.

To reset the liquid level:

- In the APP press the red RESET button on the Remote Control page and choose level - 25%, 50%, 75%, 100%
- On the controller press and HOLD the Stop button until the Power button LED flashes green 5 times to indicate the liquid level has been reset to 100%.

NOTE: Do not allow the pump to run dry as this can damage the pump and void the warranty.

WINTERIZING THE CUBE SYSTEM

Plan for the Cube tank to be nearly empty as winter approaches. Dispose of any remaining concentrate according to the product label directions.

Flush Pump & Agitation Valve

- **Unplug** the system.
- Open the **drain cap** (bottom right side) and drain the tank.
- Open the **manway cover** and rinse the inside with fresh water. Replace the drain cap. *Do not get electronics wet.*
- Rinse the suction and agitation lines inside the tank.
- Add a few inches of clean water (cover the end of the suction hose) and **close the manway cover**. *Never operate with the manway open.*
- Plug in the system.
- Turn ON and initiate an **Inspect Cycle** by pressing and **holding the Mist button for 5 seconds**, then release.
 1. Agitation cycle flushes the agitation valve.
 2. Mist cycle flushes the pump.
- Drain the tank again.
- Run a brief dry manual mist cycle to clear remaining water from the pump and agitation valve. Replace drain cap.
- Remove and store the **clear suction strainer bowl**. Do not allow water to remain inside - freezing will crack it.
- Turn the system OFF.

Purge Nozzle Circuit (Freezing Climates)

- Remove nozzle tips from the 45° adapters at the end of each run.
- Using a portable air compressor and winterizing fitting, connect air to the beginning of the nozzle circuit and purge all fluid from the lines.
- Leave nozzle tips off for winter to allow drainage.

Mild Climates (No Prolonged Hard Freeze)

Remove nozzle tips and leave them off for winter to allow drainage.

Important Notes

- Winterizing is a good time to inspect and clean nozzles.
- Standing liquid can develop slime and bacteria, which may clog the suction filter, pump, and nozzles at startup.

WARNING

Freezing liquid in the pump or motor can cause severe damage if a mist cycle runs while frozen. Damage caused by freezing is **not covered under warranty**.

LIMITED WARRANTY

Lovett Industries, LLC dba Pynamite warrants this Product to be free from defects in material and workmanship under the following terms:

Warranty Coverage

- **One (1) year** from the original date of purchase (regardless of installation date), Pynamite will repair or replace defective **electronic parts** with new or refurbished parts, at its discretion, at no charge.
- This warranty covers **parts only**. It does not include labor or costs related to diagnosing, removing, installing, shipping, servicing, or handling defective or replacement parts.
- Cube Pro systems are intended for use **within the United States only**. No exceptions will be made for systems installed outside the U.S.
- This warranty does **not** apply to **nozzles, tubing, or fittings**.
- This warranty applies only to equipment supplied by Pynamite and is in lieu of all other expressed or implied warranties.
- No person, agent, dealer, or distributor is authorized to extend additional warranties or assume liability on behalf of Pynamite.

Warranty Conditions

- Extended only to the **original purchaser** and is **nontransferable**.
- Proof of purchase is required prior to warranty service.
- Installation, use, care, and maintenance must follow the operating manual and Pynamite service guidelines. Failure to do so voids the warranty.
- Claims must be submitted promptly after discovery and no later than **one (1) year** from the original purchase date.
- Pynamite reserves the right to inspect equipment before approving any warranty claim.
- Repairs may be performed at the installation site or at Pynamite's facility in Navasota, TX. If repair is performed at Pynamite's facility, the purchaser is responsible for shipping costs.

Warranty Exclusions

This warranty does not apply to:

- Damage caused by negligence, misuse, abuse, improper adjustment, neglect, water damage to electronics, use of misting products not labeled for misting systems or containing petroleum distillates, accident, vandalism, acts of God, acts of war (declared/undeclared), improper application, or events beyond Pynamite's control.
- Cosmetic damage.
- Damage occurring during transit.
- Failures caused by products not supplied by Pynamite.
- Failures resulting from faulty installation, improper setup, improper operation, power surges, improper voltage supply, or lightning.
- Equipment repaired or altered without Pynamite authorization.
- Normal wear and tear.



866-986-5586

info@pynamite.net

www.pynamite.net

Shop our Online Store

www.mosquitoesinthemist.com

View our informational installation videos at:

<https://www.mosquitoesinthemist.com/mosquito-misting-installation-and-setup-videos/>